

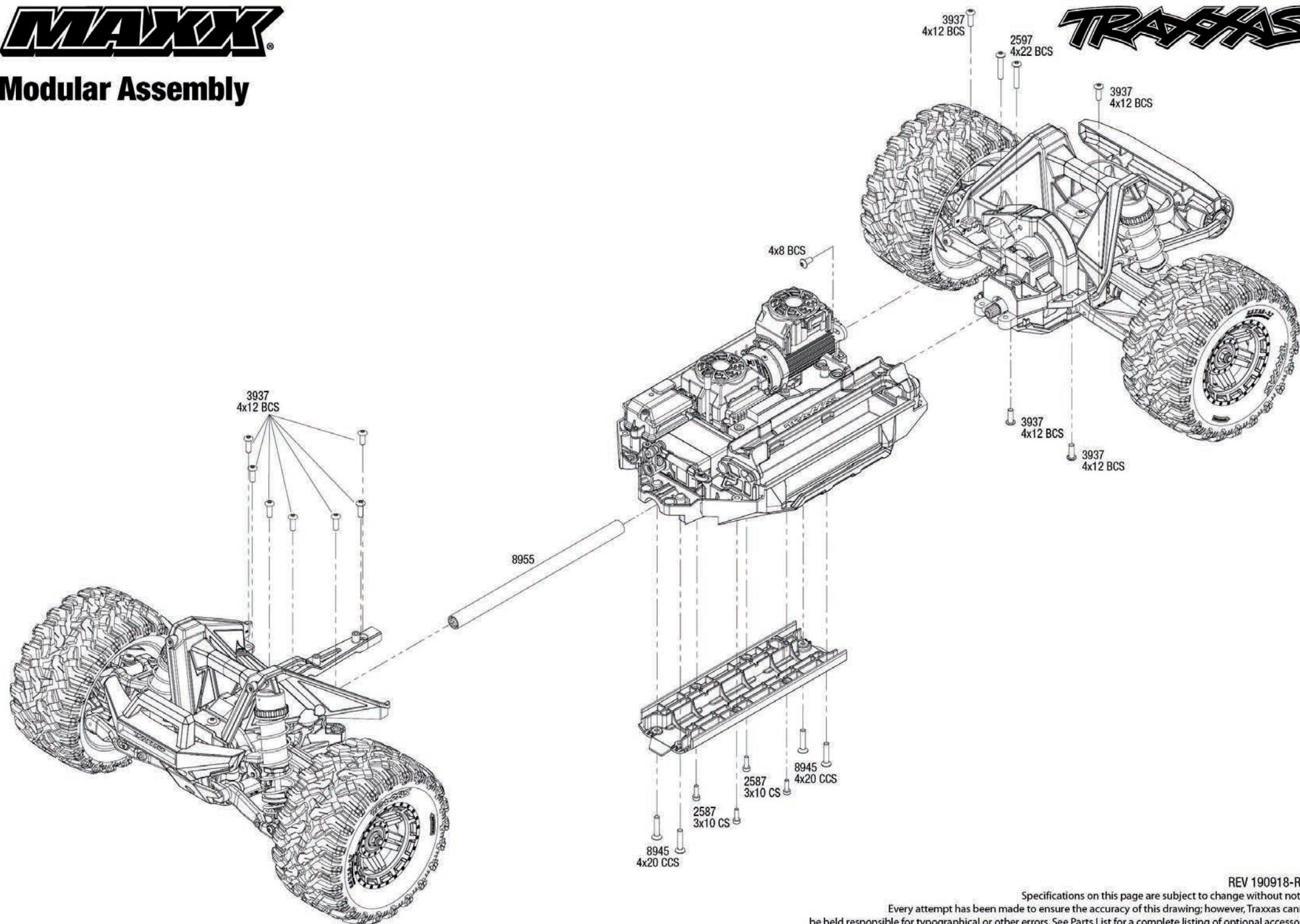

## Modular Assembly



REV 190918-R01

Specifications on this page are subject to change without notice.  
Every attempt has been made to ensure the accuracy of this drawing; however, Traxxas cannot be held responsible for typographical or other errors. See Parts List for a complete listing of optional accessories.



## Body Assembly

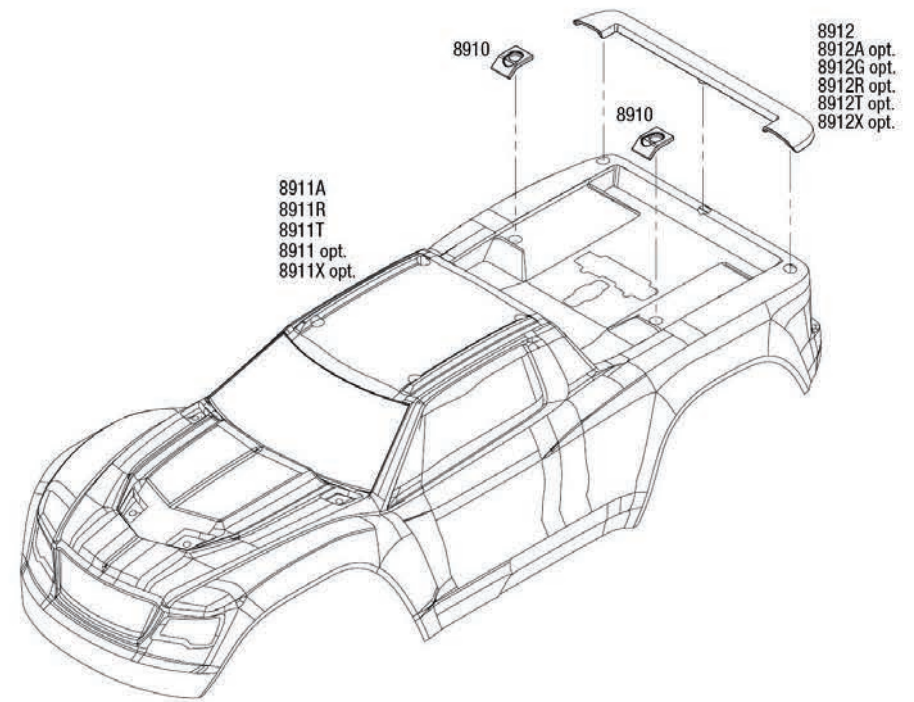
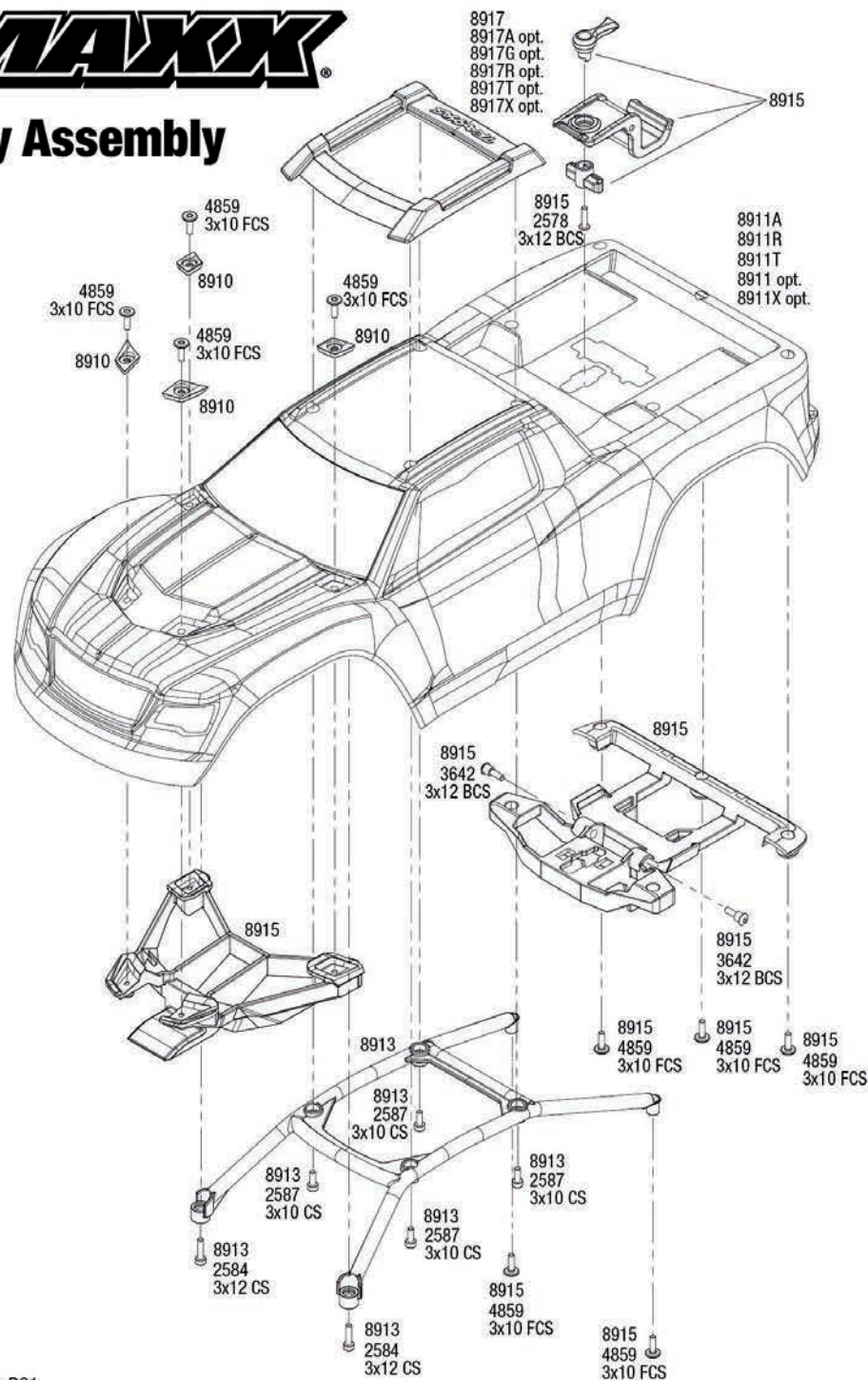

**Completed Assembly (view from bottom)**

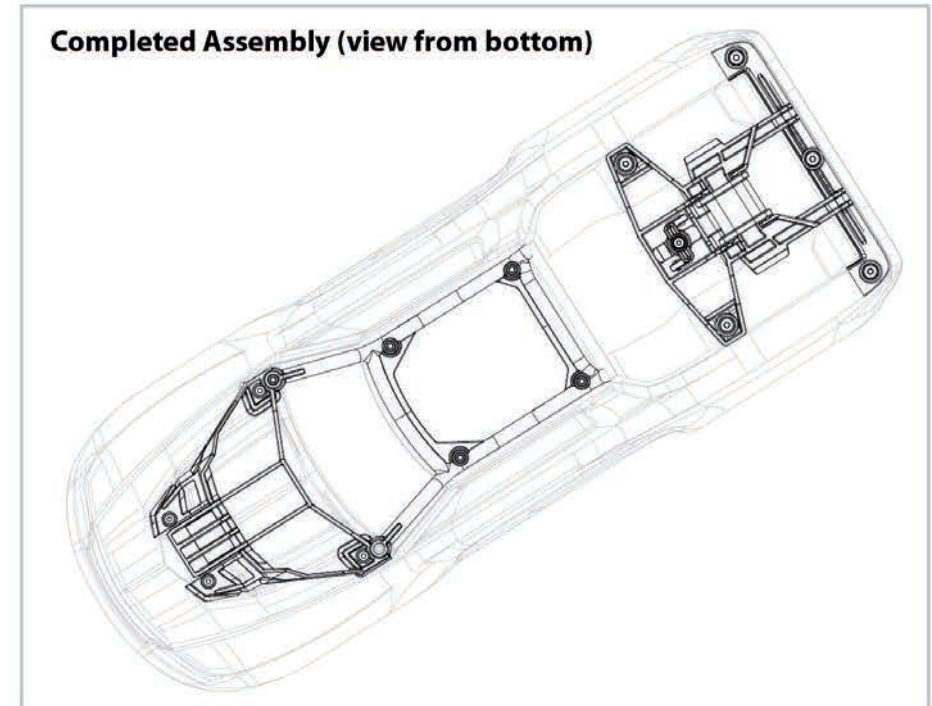

REV 190918-R01

Specifications on this page are subject to change without notice. Every attempt has been made to ensure the accuracy of this drawing; however, Traxxas cannot be held responsible for typographical or other errors. See Parts List for a complete listing of optional accessories.

See Parts List for a complete listing of optional accessories.



## Chassis Assembly

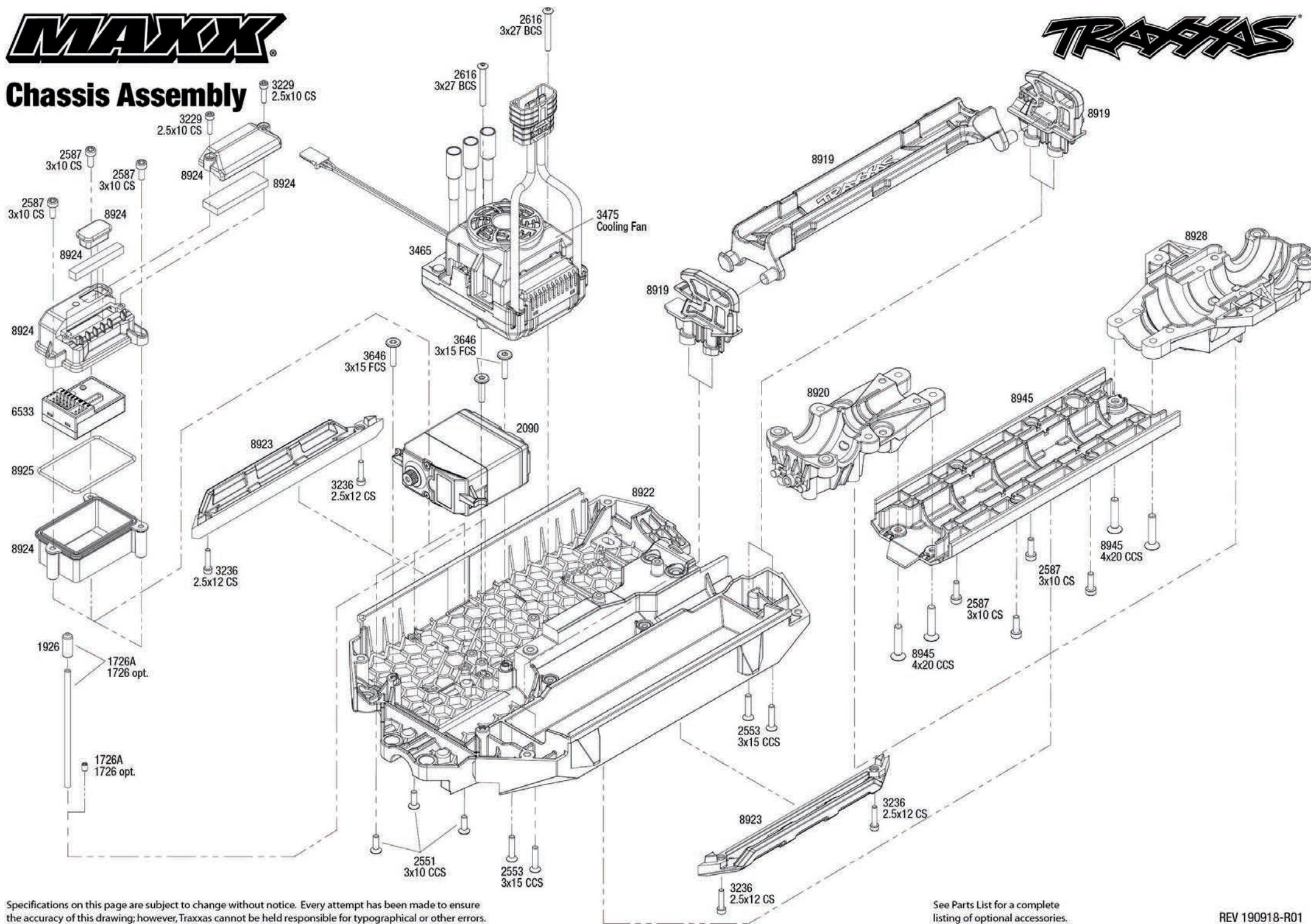

Specifications on this page are subject to change without notice. Every attempt has been made to ensure the accuracy of this drawing; however, Traxxas cannot be held responsible for typographical or other errors.

See Parts List for a complete listing of optional accessories.

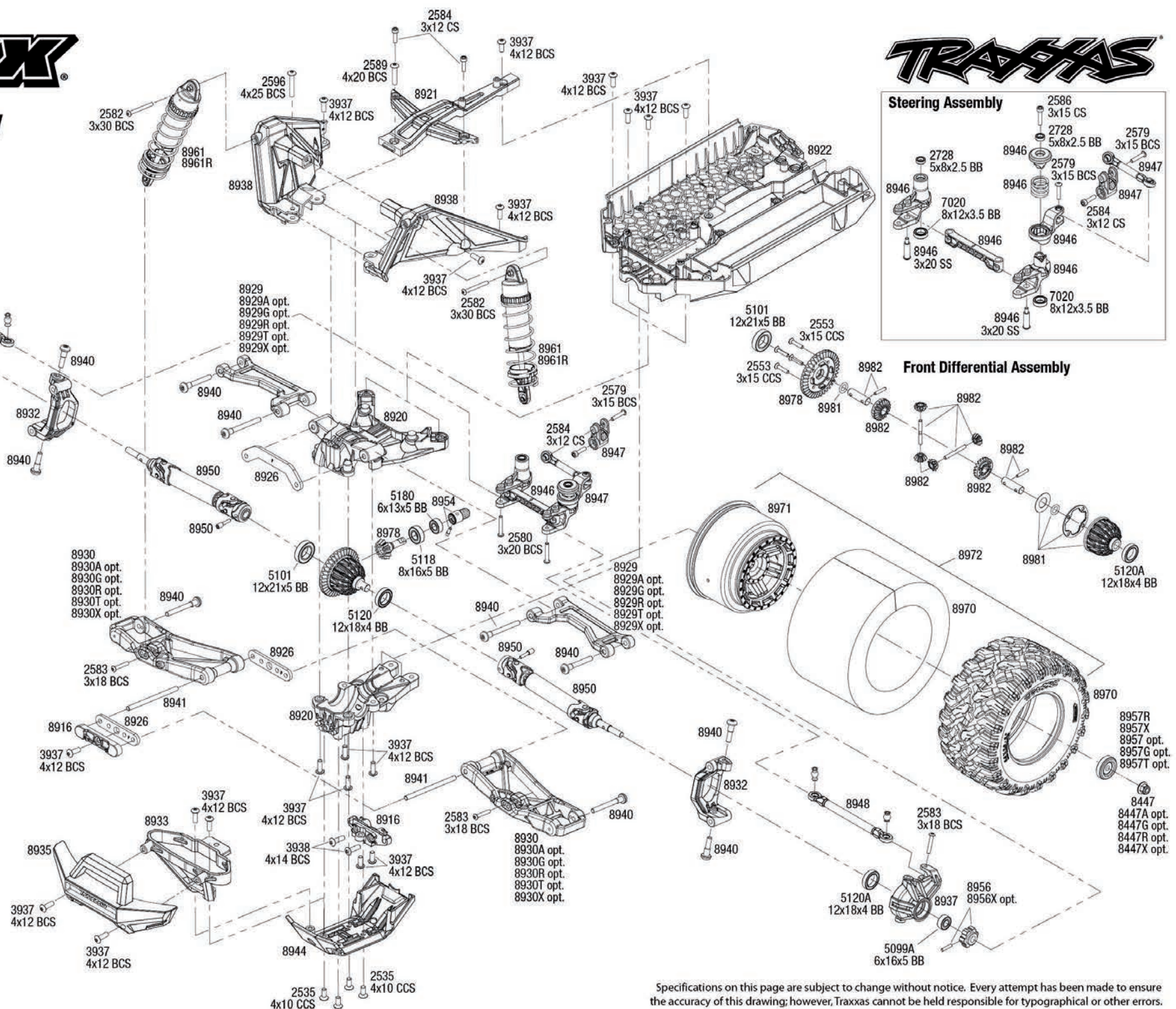
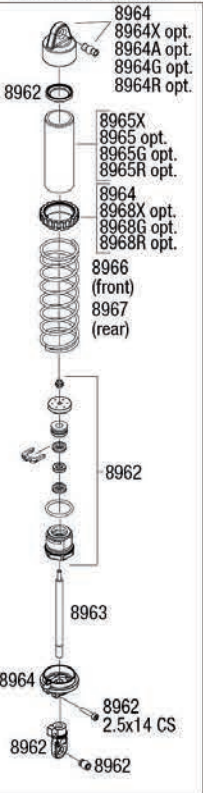
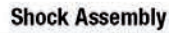
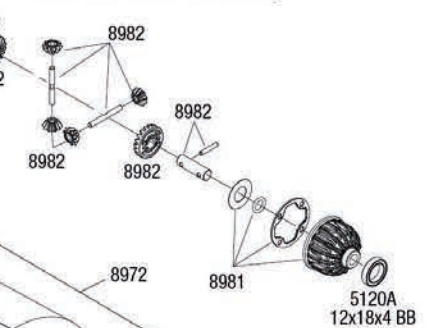
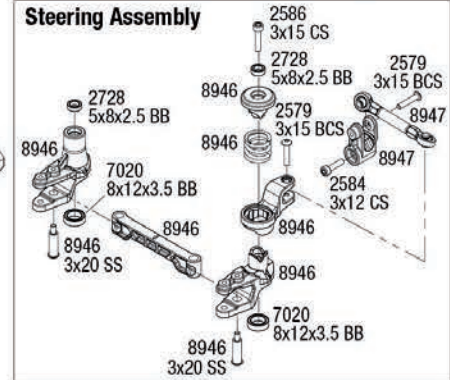

Specifications on this page are subject to change without notice. Every attempt has been made to ensure the accuracy of this drawing; however, Traxxas cannot be held responsible for typographical or other errors.

## Rear Assembly

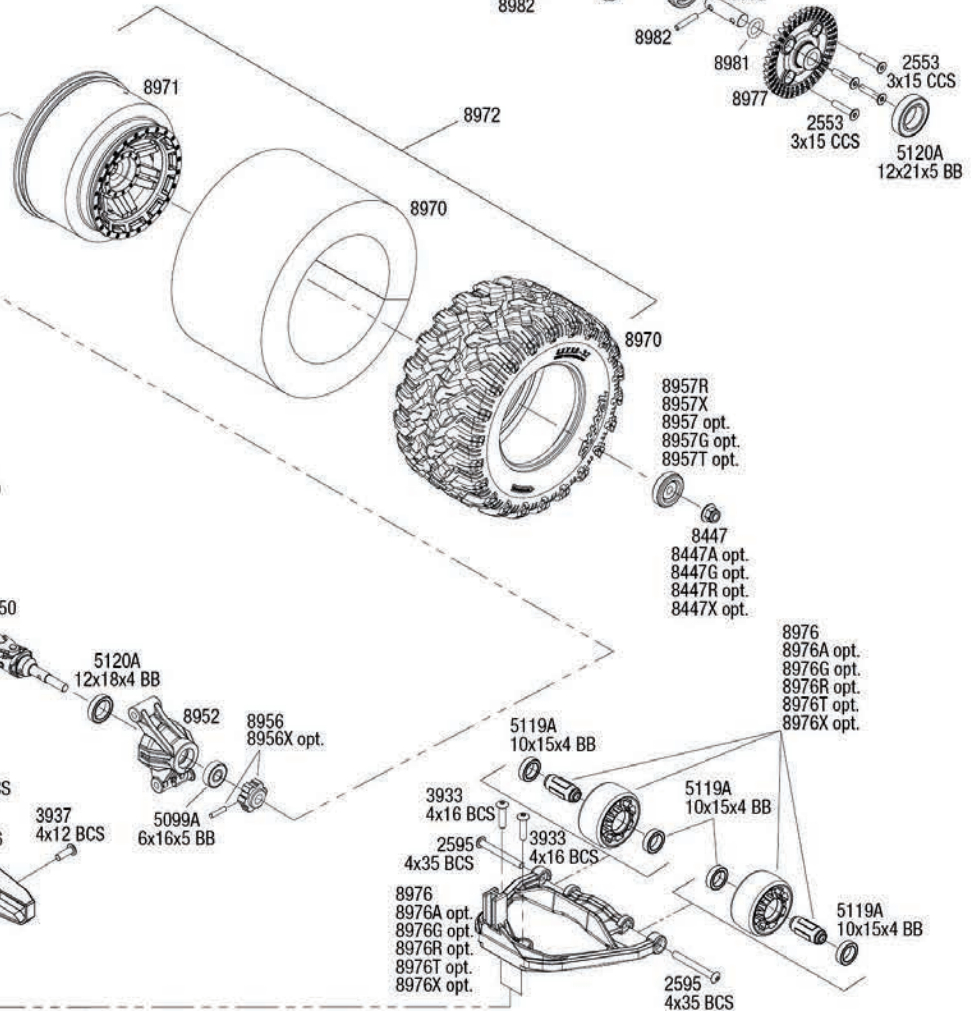
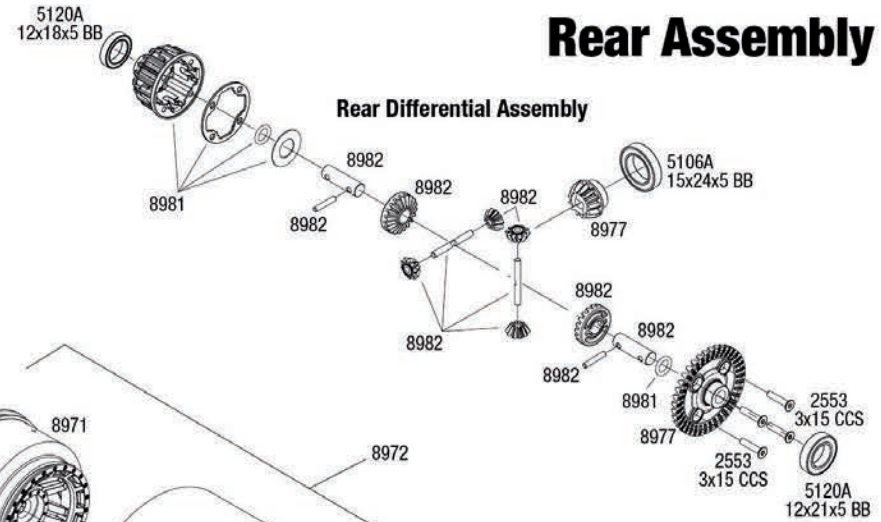

Specifications on this page are subject to change without notice. Every attempt has been made to ensure the accuracy of this drawing; however, Traxxas cannot be held responsible for typographical or other errors.



See Parts List for a complete listing of optional accessories.

[illegible]

# Cush Drive Assembly

The diagram illustrates the assembly of a Cush Drive. The components and their assembly sequence are as follows:

- 8986**: A long cylindrical shaft.
- 4955**: Two pins that fit into the shaft (8986).
- 7793X**: A large gear that is mounted onto the shaft (8986).
- 6465**: A small gear that meshes with the large gear (7793X).
- 6448, 6447 opt., 6449 opt.**: A bracket or housing that encloses the mesh between the two gears.
- 2577 3x10 BCS**: A bolt that secures the bracket to the large gear.
- 7793X**: A second large gear that is mounted onto the bracket.
- 2551 3x10 CCS**: A bolt that secures the second large gear to the bracket.

### Front & Rear Driveshaft Assembly

Exploded view diagram of the Front & Rear Driveshaft Assembly. The diagram shows the front driveshaft (8949) with a yoke (8953) and a U-bolts (5452) assembly. The rear driveshaft (8953) is shown with a yoke (8953) and a U-bolts (5452) assembly. The central shaft (8953) is shown with a yoke (8953) and a U-bolts (5452) assembly. The diagram is labeled with part numbers 8949, 8953, and 5452.

REV 190918-R01

Specifications on this page are subject to change without notice. Every attempt has been made to ensure the accuracy of this drawing; however, Traxxas cannot be held responsible for typographical or other errors.